

Wireless Printing on Apple Phones/Devices

1. Connect to the library's WiFi – CCPLD_WiFi and agree to the terms to log in.
2. The wireless printer utilizes the AirPrint service to print.
3. Open the application you wish to print from and choose the  symbol.

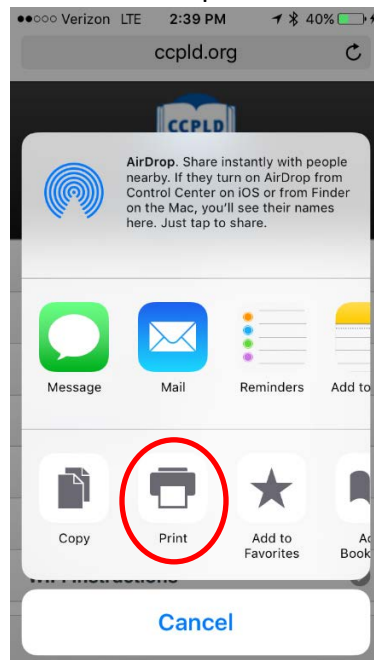

4. This opens a menu – from this menu choose print.



5. The print menu will open – choose Select Printer and then CCPLD WiFi Printer when it appears in the list.

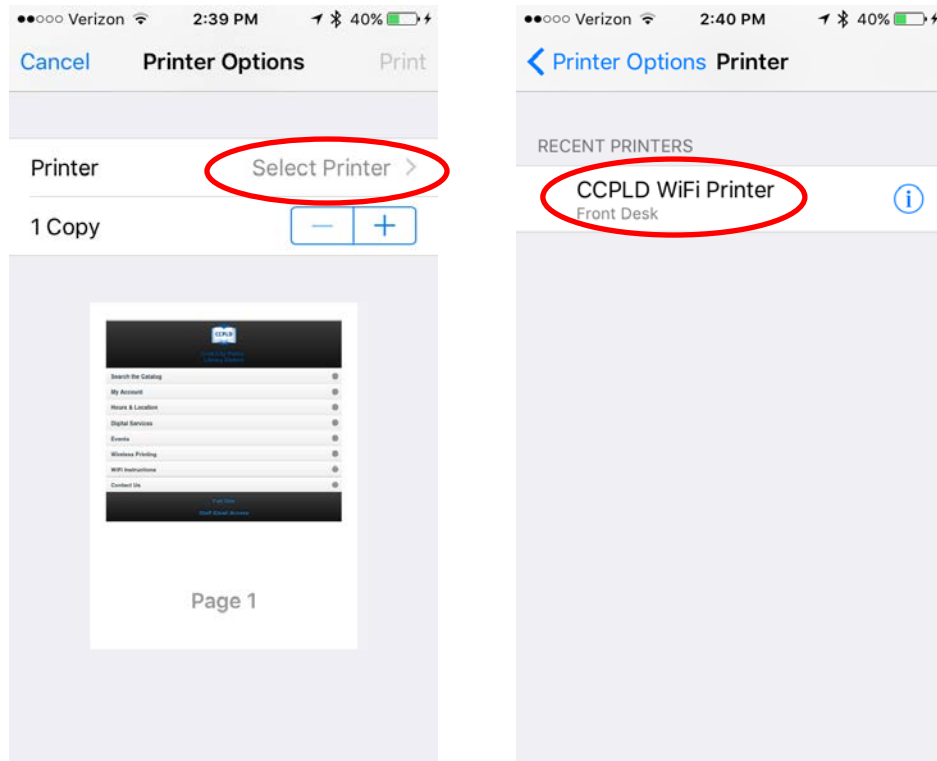

6. Next click Print.

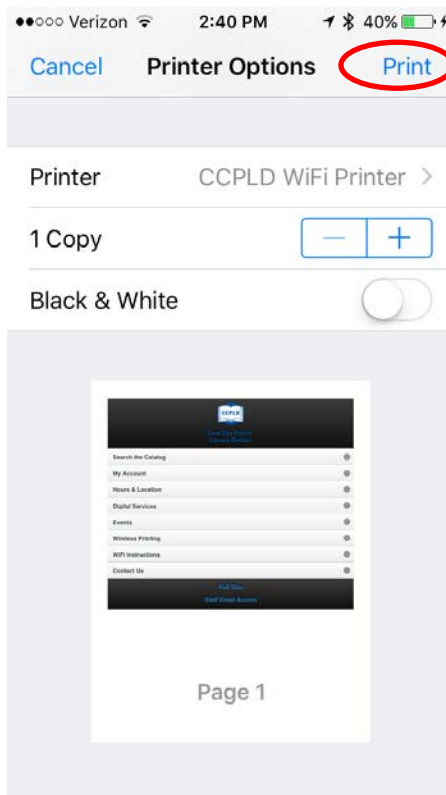

7. The document will now be sent to the printer.

